





T-STRIPE Montageplan STANDARDFENSTER

Legende:

- T-STRIPE Heizelement $\varnothing 3,8\text{mm}$ 
- T-STRIPE Design Aluleiste 
- Anschlußgarnitur 
- Temperaturfühler 
- Temperaturfühleradapter 
- Thermostat 

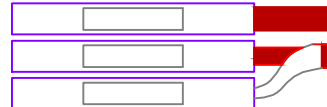
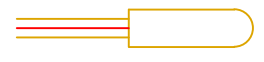
Y

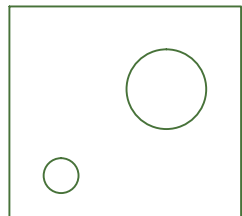
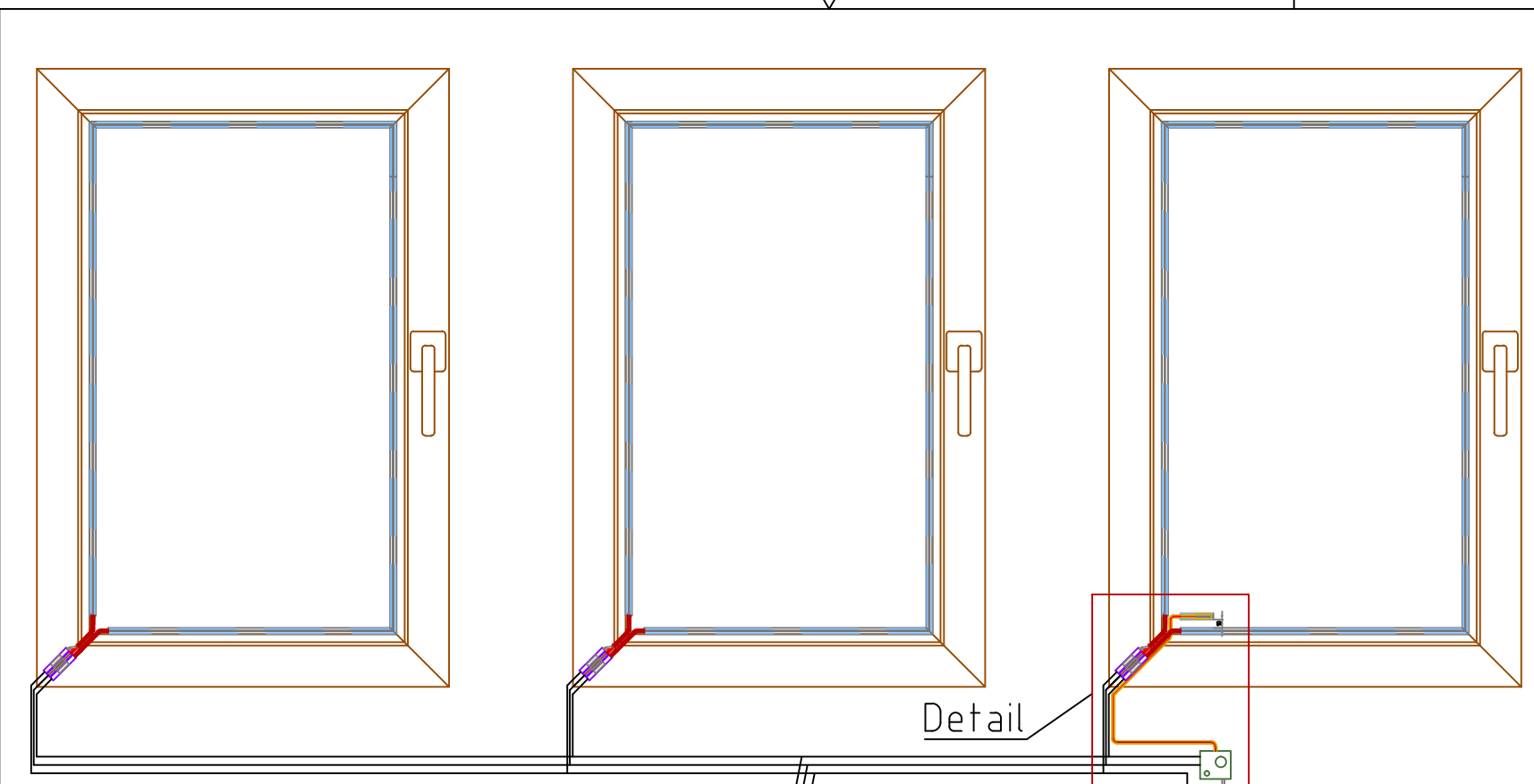

N
L
PE
Hausstromnetz
230V

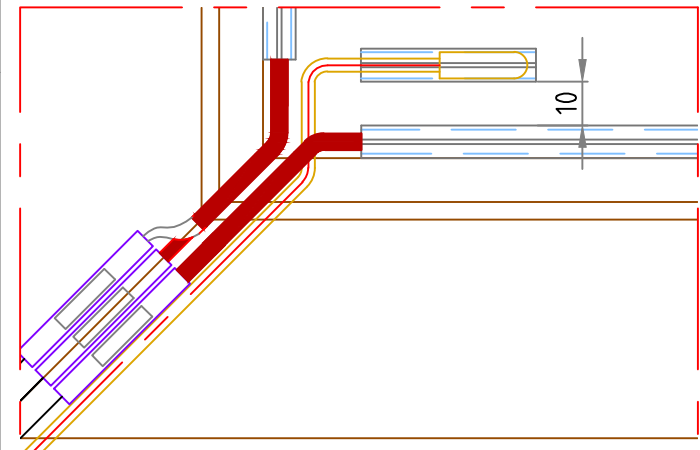

10

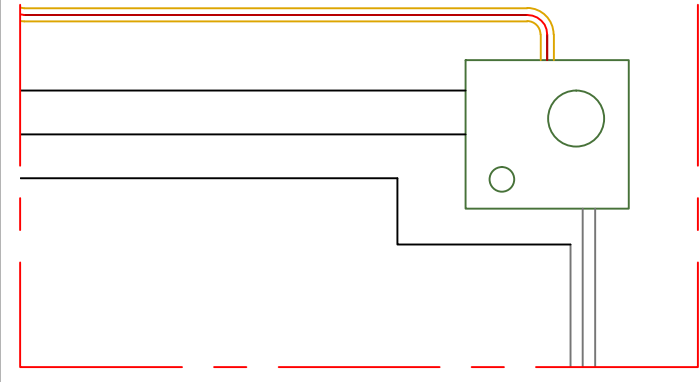

Montage neben der Glasleiste

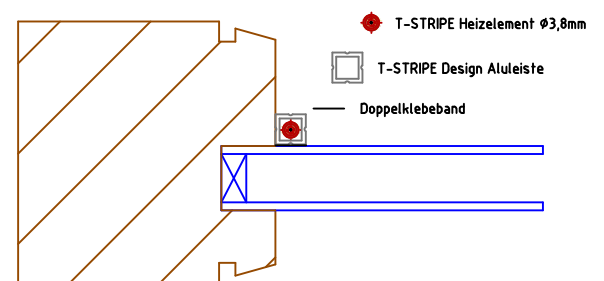

Montage hinter der Glasleiste

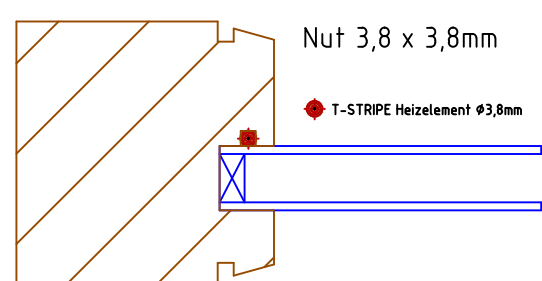

Pos.	Stk.	Bezeichnung	Abmessungen	Material	Gew.
A.005	1	Thermostat mit ext. Temp. Fühler	230V	-	000,0
A.004	1	Netzkabel 3 x 0,5mm ² Litzenkabel	230V	-	000,0
A.003	1	Temperaturfühler	230V	-	000,0
A.002	3	Anschlußgarnitur	230V	-	000,0
A.001	3	Heizelement	L = nach bedarf	-	000,0

TECHNISCHES ZEICHENBÜRO
Reinhard Wallner
A-2521 Trumau, Gartengasse 1
Tel.: 0664 / 35 73 930



Rev	Changes	Date	Name	Changed to	Plot Date
G					
F			Drafted		
E			Finished		
D			Checked		
C			Directory		
B			CAD - System	AUTOCAD 14	
A			Made from		

Date	Name	Customer / Project	Scale
17.09.	r.w.	T-STRIPE	1:20
Plant / View / Part		Standardfenster	
		T-STRIPE Verlegeplan	
Drawing No		12.025-001	Templ. A2q

CAD - Drawing must not be changed manually !